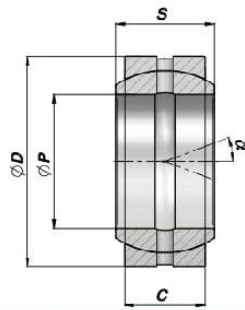

ROTULE "GE" - GE" BEARINGS

TABLEAU COMPARATIF ROTULES "GE" CROSS REFERENCE SPHERICAL PLAIN BEARINGS

CONTARINI	SKF	INA	International Reference
GE ... DO	GE ... E/ES	GE ... DO	GE ... E/ES
GE ... DO2RS	GE ... ES-2RS	GE ... DO-2RS	GE ... ES-2RS
GE ... LO	GEG ... ES	GE ... LO	GEEW ... ES
GE ... HO2RS	GEM ... ES-2RS	GE ... HO-2RS	GEEM ... ES-2RS
GE ... FO	GEH ... ES	GE ... FO	GEG ... ES
GE ... FO2RS	GEH ... ES-2RS	GE ... FO-2RS	GEG ... ES-2RS
GE ... UK	GE ... C	GE ... UK	GE ... C
GE ... UK2RS	GE ... TXE-2LS / TXA-2LS	GE ... UK-2RS	GE ... ET-2RS
GE ... FW	GEH ... C	GE ... FW	GEG ... C
GE ... FW2RS	GEH ... TXE-2LS / TXA-2LS	GE ... FW-2RS	GEG ... ET/XT ... -2RS
GE ... TGR	GE ... TXGR	-	GE ... ET-X
GE ... TGR2RS	GE ... TXG3E-2LS / TXG3A-2LS	-	GE ... XT ... -2RS X
GE ... ZO	GEZ ... ES	GE ... ZO	GEZ ... ES
GE ... ZO2RS	GEZ ... ES-2RS	GE ... ZO-2RS	GEZ ... ES-2RS
GE ... SX	-	GE ... SX	GAC ... S
GE ... SW	GAC ... F	GE ... SW	GAC ... T
GE ... AX	-	GE ... AX	GX ... S
GE ... AW	GX ... F	GE ... AW	GX ... T

ROTULE RADIALE DEMANDANT ENTRETIEN
RADIAL BALL-JOINT REQUIRING MAINTENANCE
GE DO/GE D02RS

TYPE DO

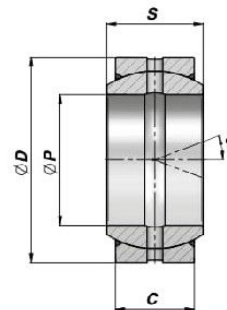

TYPE DO...2RS



Code Code Type DO	Code Code Type DO...2RS	ØP	ØD	S	C	α	FC (kN)	kg
*CGE0100000	NEW! -	10	19	9	6	12	8.15	0,01
*CGE0120000	-	12	22	10	7	11	10.80	0,01
CGE0150000	CGE0001425	15	26	12	9	8	17.00	0,02
CGE0160000 (A)	-	16	30	14	10	10	21.20	0,03
CGE0170000	CGE0001426	17	30	14	10	10	21.20	0,04
CGE0200000	CGE0001427	20	35	16	12	9	30.00	0,06
CGE0250000	CGE0001428	25	42	20	16	7	48.00	0,11
CGE0300000	CGE0001429	30	47	22	18	6	62.00	0,14
CGE0350000	CGE0001430	35	55	25	20	6	80.00	0,22
CGE0400000	CGE0001431	40	62	28	22	7	100.00	0,30
CGE0450000	CGE0001432	45	68	32	25	7	127.00	0,40
CGE0500000	CGE0001433	50	75	35	28	6	156.00	0,54
CGE0600000	CGE0001434	60	90	44	36	6	245.00	1,00
CGE0700000	CGE0001435	70	105	49	40	6	315.00	1,50
CGE0800000	CGE0001436	80	120	55	45	6	400.00	2,20
CGE0900000	CGE0001437	90	130	60	50	5	490.00	2,70
CGE1000000	CGE0001438	100	150	70	55	7	610.00	4,30
CGE1100000	CGE0001439	110	160	70	55	6	655.00	4,70
CGE1200000	CGE0001440	120	180	85	70	6	950.00	8,00
CGE1400000	NEW! CGE0001441	140	210	90	70	7	1080.00	11,00
CGE1600000	NEW! CGE0001442	160	230	105	80	8	1370.00	13,50
CGE1800000	NEW! CGE0001443	180	260	105	80	6	1530.00	18,50
CGE2000000	NEW! CGE0001444	200	290	130	100	7	2120.00	28,00

FC = CHARGE DYN. MAXI - MAX DYNAMIC LOAD

* = SANS GRAISSEUR - WITHOUT GREASE NIPPLE

(A) = SANS NORME - OUT OF RULE

ACCOUPLLEMENT - COUPLING : ACIER/ACIER - STEEL/STEEL

MATERIEL : ACIER ISO 12240-1 SERIE E

MATERIAL : STEEL ISO 12240-1 SERIES E