

XV-0M COURBES CARACTERISTIQUE DE DEBIT

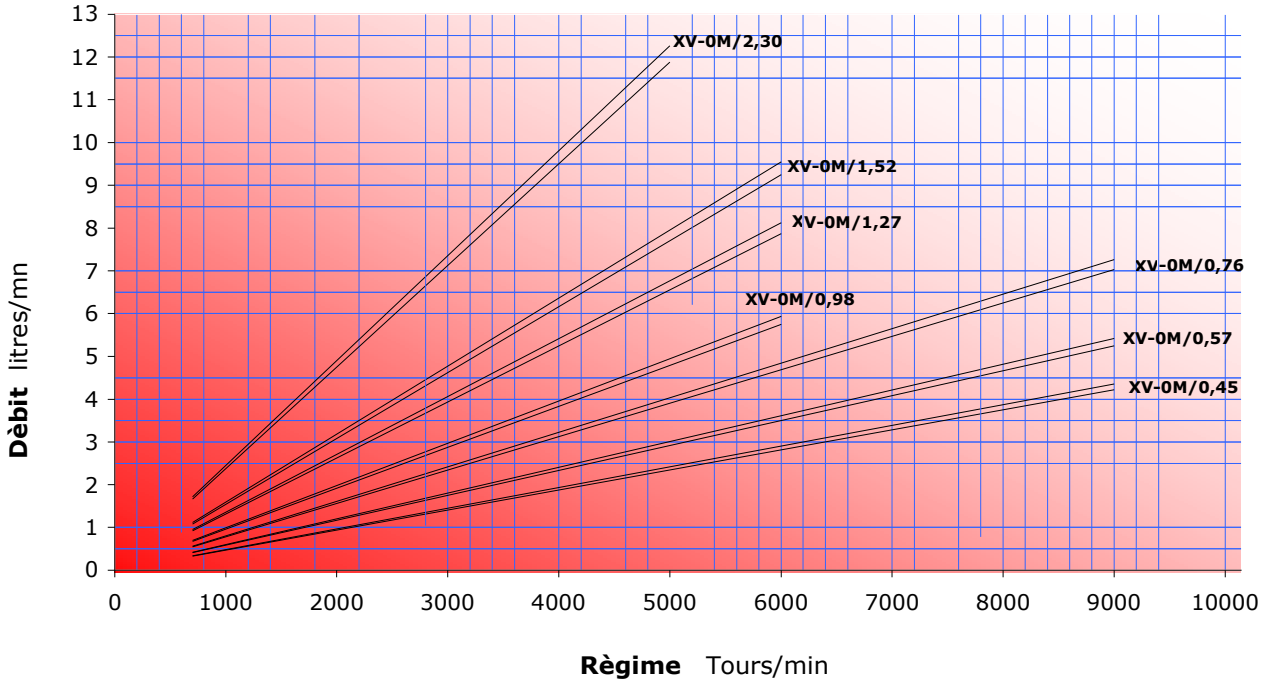

XV-0M COUPLE MOTEUR

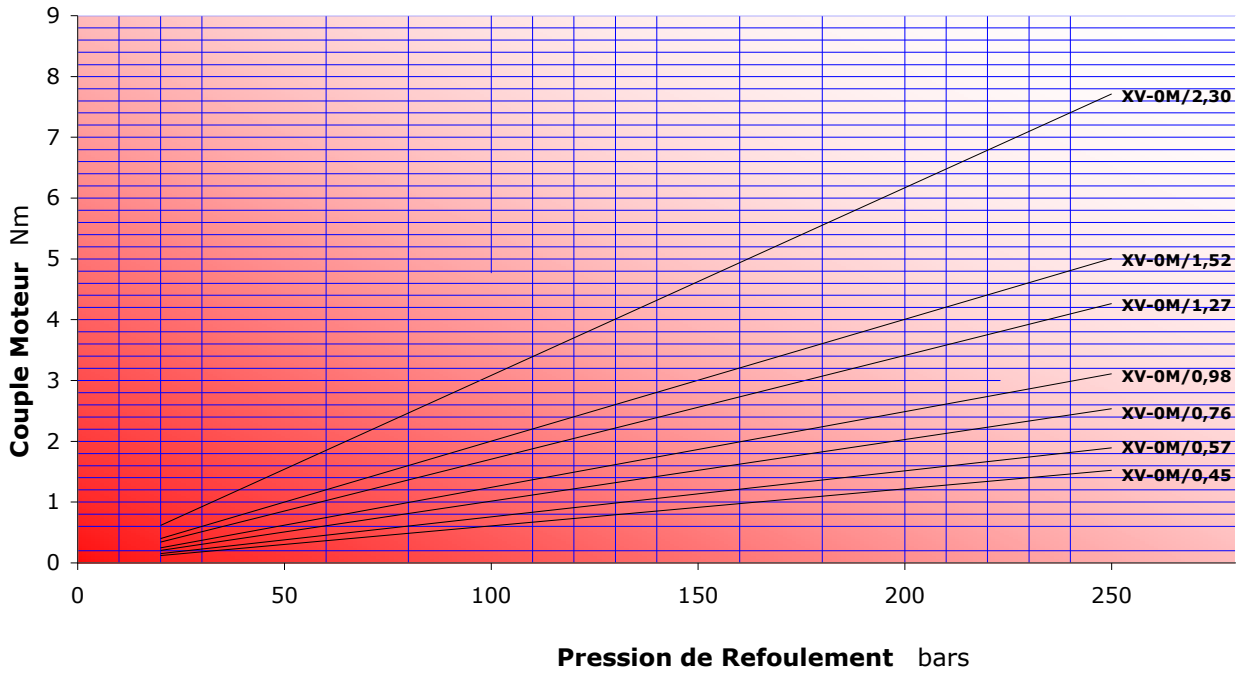

moteur réversible - série XV

XV-0M

MOTEUR STANDARD

FLASQUE AVANT Ø22 - ARBRE CYLINDRIQUE

X 0 M 06 01 A B B E

Série	X	série XV
Groupe	0	groupe 0
Catégorie	M	moteur réversible
Cylindrée	06	0.76
Flasque avant	01	Ø22 rotation réversible
Arbre	A	Cl001 - Cylindrique ø7 - M7x1 - clavette épaisseur 2
Corps	IN	aspiration - 1/4" GAS
	OUT	refoulement - 1/4" GAS
Couvercle	E	réversible avec drainage externe

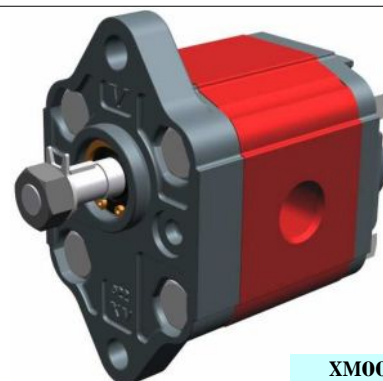

XM001

Tableau des données techniques

TYPE	Cylindrée cm³/tour	Pression Max.		DRAINAGE	
		P1 bar	P3 bar	Drainage extérieur	Drainage intérieur
XV-0M/0.45	0,45	220	280	X 0 M 04 01 A B B E	X 0 M 04 01 A B B F
XV-0M/0.57	0,56	220	280	X 0 M 05 01 A B B E	X 0 M 05 01 A B B F
XV-0M/0.76	0,75	220	280	X 0 M 06 01 A B B E	X 0 M 06 01 A B B F
XV-0M/0.98	0,92	220	280	X 0 M 07 01 A B B E	X 0 M 07 01 A B B F
XV-0M/1.27	1,26	220	280	X 0 M 09 01 A B B E	X 0 M 09 01 A B B F
XV-0M/1.52	1,48	220	280	X 0 M 11 01 A B B E	X 0 M 11 01 A B B F
XV-0M/2.30	2,28	190	210	X 0 M 13 01 A B B E	X 0 M 13 01 A B B F

P1) Pression max de service - P3) Pression max de pointe

Pour applications lourdes il est conseillé de vérifier le couple admissible de l'arbre



Tableau des dimensions

TYPE	Poids	A	B	C	D	D
	kg	mm	mm	mm	IN	OUT
XV-0M/0.45	0,420	58,0	27,3	49,0	1/4" BSPP	1/4" BSPP
XV-0M/0.57	0,430	59,0	27,8	50,0	1/4" BSPP	1/4" BSPP
XV-0M/0.76	0,440	60,5	28,5	51,5	1/4" BSPP	1/4" BSPP
XV-0M/0.98	0,460	62,0	29,3	53,0	1/4" BSPP	1/4" BSPP
XV-0M/1.27	0,480	64,5	30,5	55,5	1/4" BSPP	1/4" BSPP
XV-0M/1.52	0,500	66,5	31,5	57,5	1/4" BSPP	1/4" BSPP
XV-0M/2.30	0,560	72,5	34,5	63,5	1/4" BSPP	1/4" BSPP

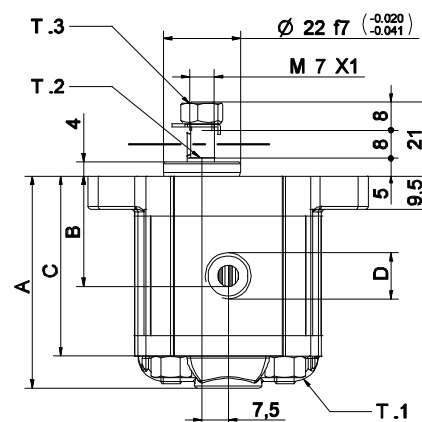
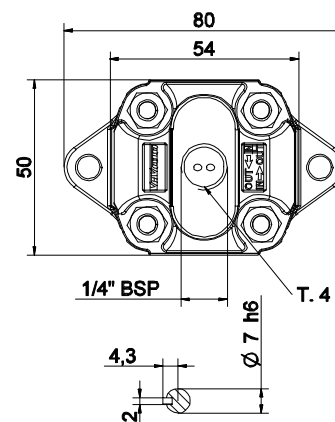
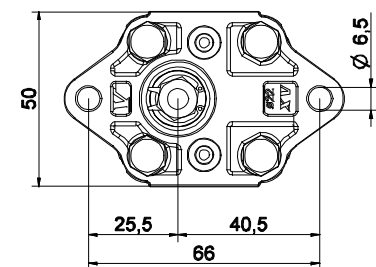

26/08/04 X0R0601ABBE.iff

T.1 = 11.7±13.7 [Nm] - couple de serrage vis M6

T.3 = 11.5 [Nm] - couple de serrage - clé 11

T.2 = 2.1 [Nm] - couple admissible de l'arbre (N.B. Pour le choix de l'arbre, vérifier toujours le couple admissible).

FLASQUE AVANT ø22 Standard

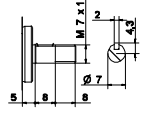
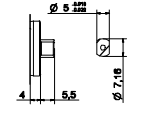
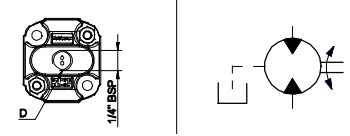
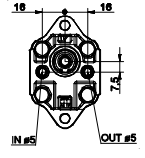
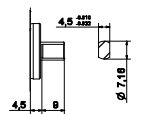
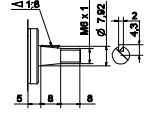
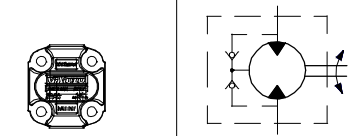
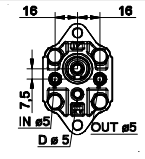
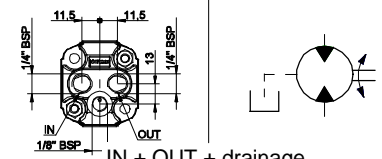
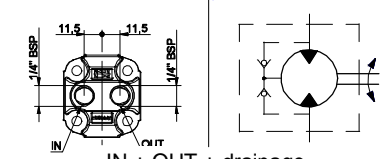
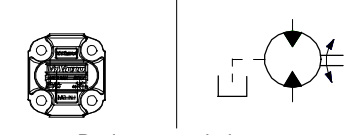
FLASQUE AVANT ø22 Standard		Arbre		Couvercle			
	01	CI001 - Cylindrique T.2 = 2.1 [Nm] 	A	CF001 - Queue fraisée T.2 = 9.2 [Nm] 	B	 Drainage extérieur	E
	04	CF005 - Queue fraisée T.2 = 8.4 [Nm] 	F	CO001 - Conique T.2 = 21.9 [Nm] 	E	 Drainage intérieur	F
	05			 IN + OUT + drainage	K	K	
				 IN + OUT + drainage	L	L	
				 Drainage sur la base	P	P	

Cylindrée	
TYPE	CODE
XV-0M/0.45	04
XV-0M/0.57	05
XV-0M/0.76	06
XV-0M/0.98	07
XV-0M/1.27	09
XV-0M/1.52	11
XV-0M/2.30	13

Corps standard			
Cylindrée	cm ³ /tour	Filetages standard	
0.17		B - B	Z - Z
0.25		B - B	Z - Z
0.45		B - B	Z - Z
0.57		B - B	Z - Z
0.76		B - B	Z - Z
0.98		B - B	Z - Z
1.27		B - B	Z - Z
1.52		B - B	Z - Z
2.30		B - B	Z - Z

Tableau des combinaisons des bridages et filetages standard disponibles en magasin

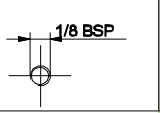
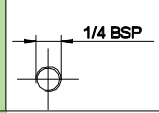
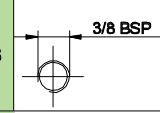
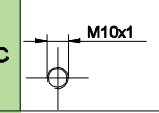
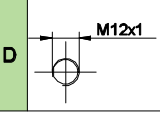
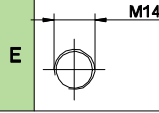
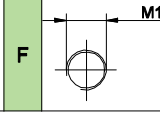
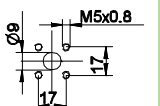
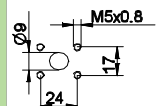
Corps (filetages et bridages)													
	A		B		C		D		E		F		G
	H		I	Corps Renfermé		Z							

moteur réversible - série XV

XV-0M

MOTEUR TYPE "BH"

FLASQUE AVANT Ø22 MODELE - ARBRE QUEUE FRAISEE

X	0	M	06	07	B	B	B	E
Série	X	série XV						
Groupe	0	groupe 0						
Catégorie	M	moteur réversible						
Cylindrée	06	0.76						
Flasque avant	07	Ø22 BH rotation réversible						
Arbre	B	CF001 - Queue fraisée ø7 - épaisseur 5						
Corps	IN	B aspiration - 1/4" GAS						
	OUT	B refoulement - 1/4" GAS						
Couvercle	E	réversible avec drainage externe						



XM012

Tableau des données techniques																					
TYPE	Cylindrée	Pression Max.		LUBR																	
		cm³/tour	P1 bar	P3 bar	Drainage extérieur				Drainage intérieur												
XV-0M/0.45	0,45	220	280	X	0	M	04	07	B	B	B	E	X	0	M	04	07	B	B	B	F
XV-0M/0.57	0,56	220	280	X	0	M	05	07	B	B	B	E	X	0	M	05	07	B	B	B	F
XV-0M/0.76	0,75	220	280	X	0	M	06	07	B	B	B	E	X	0	M	06	07	B	B	B	F
XV-0M/0.98	0,92	220	280	X	0	M	07	07	B	B	B	E	X	0	M	07	07	B	B	B	F
XV-0M/1.27	1,26	220	280	X	0	M	09	07	B	B	B	E	X	0	M	09	07	B	B	B	F
XV-0M/1.52	1,48	220	280	X	0	M	11	07	B	B	B	E	X	0	M	11	07	B	B	B	F
XV-0M/2.30	2,28	190	210	X	0	M	13	07	B	B	B	E	X	0	M	13	07	B	B	B	F

P1) Pression max de service - P3) Pression max de pointe
 Pour applications lourdes il est conseillé de vérifier le couple admissible de l'arbre



Tableau des dimensions						
TYPE	Poids	A	B	C	D	D
	kg	mm	mm	mm	IN	OUT
XV-0M/0.45	0,420	58,0	27,3	49,0	1/4" BSPP	1/4" BSPP
XV-0M/0.57	0,430	59,0	27,8	50,0	1/4" BSPP	1/4" BSPP
XV-0M/0.76	0,440	60,5	28,5	51,5	1/4" BSPP	1/4" BSPP
XV-0M/0.98	0,460	62,0	29,3	53,0	1/4" BSPP	1/4" BSPP
XV-0M/1.27	0,480	64,5	30,5	55,5	1/4" BSPP	1/4" BSPP
XV-0M/1.52	0,500	66,5	31,5	57,5	1/4" BSPP	1/4" BSPP
XV-0M/2.30	0,560	72,5	34,5	63,5	1/4" BSPP	1/4" BSPP



26/08/04 XOR0607B8BE.dff

T.1 = 11.7±13.7 [Nm] - couple de serrage vis M6
 T.2 = 9.2 [Nm] - couple admissible de l'arbre (N.B. Pour le choix de l'arbre, vérifier toujours le couple admissible).

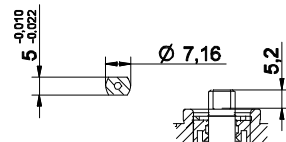
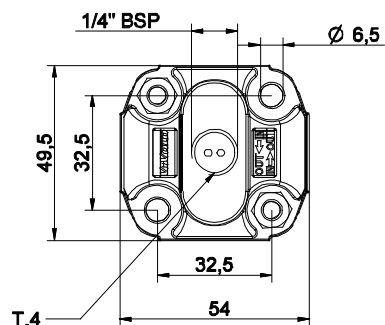
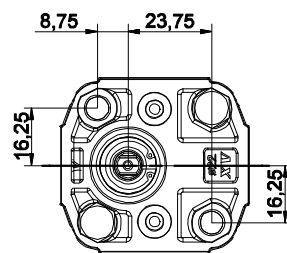
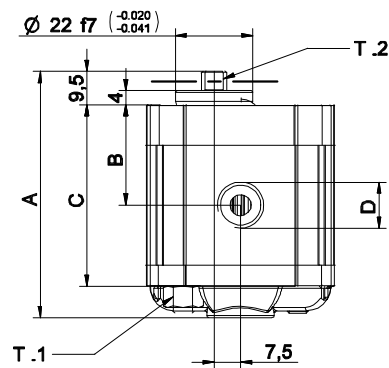
Planche des variantes

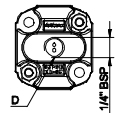
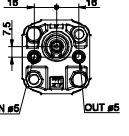
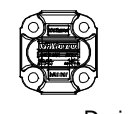
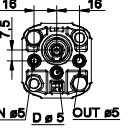
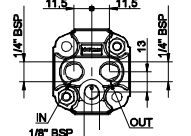
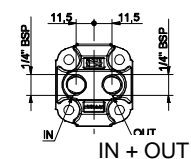
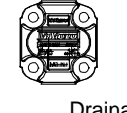

FLASQUE AVANT $\varnothing 22$ - "BH" gabarié

FLASQUE AVANT $\varnothing 22$ - "BH" gabarié		Arbre		Couvercle			
	07	C1001 - Cylindrique T.2 = 2.1 [Nm]	A	CF001 - Queue fraisée T.2 = 9.2 [Nm]	B	 Drainage extérieur	E
		10	CF005 - Queue fraisée T.2 = 8.4 [Nm]	F	CO001 - Conique T.2 = 21.9 [Nm]	E	 Drainage intérieur
	11						 IN + OUT + drainage
							 IN + OUT + drainage
						 Drainage sur la base	P

Cylindrée	
TYPE	CODE
XV-0M/0.45	04
XV-0M/0.57	05
XV-0M/0.76	06
XV-0M/0.98	07
XV-0M/1.27	09
XV-0M/1.52	11
XV-0M/2.30	13

Corps standard			
Cylindrée	cm ³ /tour	Filetages standard	
		0.17	B - B
0.25	B - B	Z - Z	
0.45	B - B	Z - Z	
0.57	B - B	Z - Z	
0.76	B - B	Z - Z	
0.98	B - B	Z - Z	
1.27	B - B	Z - Z	
1.52	B - B	Z - Z	
2.30	B - B	Z - Z	

Tableau des combinaisons des bridages et filetages standard disponibles en magasin

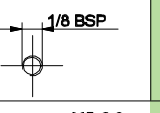
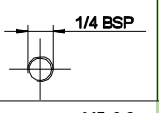
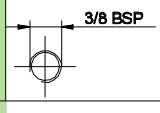
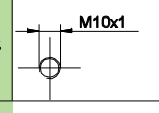
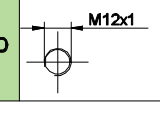
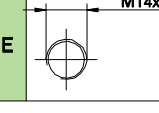
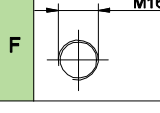
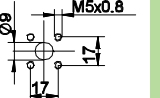
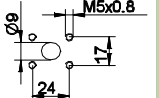
Corps (filetages et bridages)													
	A		B		C		D		E		F		G
	H		I	Corps Renfermé		Z							

moteur réversible - série XV

XV-0M

MOTEUR TYPE "HY"

FLASQUE AVANT Ø22 MODELE - ARBRE QUEUE FRAISEE

X 0 M 06 21 B B B E

Série	X	série XV
Groupe	0	groupe 0
Catégorie	M	moteur réversible
Cylindrée	06	0.76
Flasque avant	21	Ø22 HY rotation réversible
Arbre	B	CF001 - Queue fraisée ø7 - épaisseur 5
Corps	IN	B aspiration - 1/4" GAS
	OUT	B refoulement - 1/4" GAS
Couvercle	E	réversible avec drainage externe



XM017

Tableau des données techniques

TYPE	Cylindrée cm ³ /tour	Pression Max.		DRAINAGE	
		P1 bar	P3 bar	Drainage extérieur	Drainage intérieur
XV-0M/0.45	0,45	220	280	X 0 M 04 21 B B B E	X 0 M 04 21 B B B F
XV-0M/0.57	0,56	220	280	X 0 M 05 21 B B B E	X 0 M 05 21 B B B F
XV-0M/0.76	0,75	220	280	X 0 M 06 21 B B B E	X 0 M 06 21 B B B F
XV-0M/0.98	0,92	220	280	X 0 M 07 21 B B B E	X 0 M 07 21 B B B F
XV-0M/1.27	1,26	220	280	X 0 M 09 21 B B B E	X 0 M 09 21 B B B F
XV-0M/1.52	1,48	220	280	X 0 M 11 21 B B B E	X 0 M 11 21 B B B F
XV-0M/2.30	2,28	190	210	X 0 M 13 21 B B B E	X 0 M 13 21 B B B F

P1) Pression max de service - P3) Pression max de pointe

Pour applications lourdes il est conseillé de vérifier le couple admissible de l'arbre



Tableau des dimensions

TYPE	Poids	A	B	C	D	D
	kg	mm	mm	mm	IN	OUT
XV-0M/0.45	0,420	58,0	27,3	49,0	1/4" BSPP	1/4" BSPP
XV-0M/0.57	0,430	59,0	27,8	50,0	1/4" BSPP	1/4" BSPP
XV-0M/0.76	0,440	60,5	28,5	51,5	1/4" BSPP	1/4" BSPP
XV-0M/0.98	0,460	62,0	29,3	53,0	1/4" BSPP	1/4" BSPP
XV-0M/1.27	0,480	64,5	30,5	55,5	1/4" BSPP	1/4" BSPP
XV-0M/1.52	0,500	66,5	31,5	57,5	1/4" BSPP	1/4" BSPP
XV-0M/2.30	0,560	72,5	34,5	63,5	1/4" BSPP	1/4" BSPP

T.1 = 11.7±13.7 [Nm] - couple de serrage vis M6

T.2 = 9.2 [Nm] - couple admissible de l'arbre (N.B. Pour le choix de l'arbre, vérifier toujours le couple admissible).

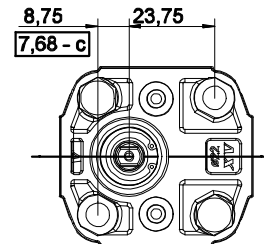
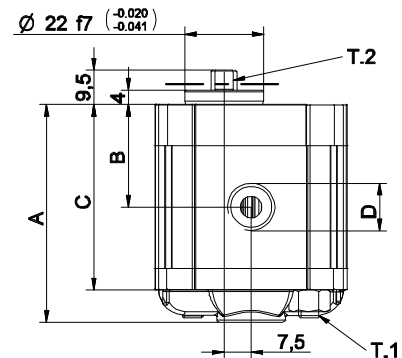
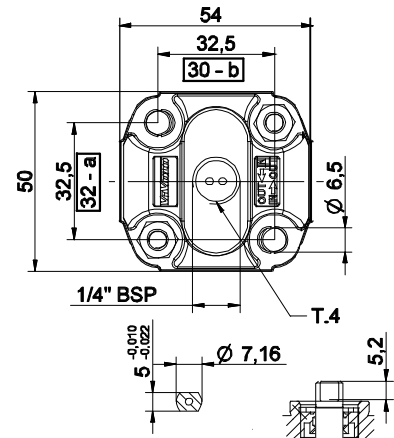
NOTE: Ce type de pompe est aussi interchangeable avec entre-axes de fixation in M5 (voir cotes a, b, c).

26/08/04 XOR062188BE.dft

Planche des variantes



FLASQUE AVANT ø22 - "HY" gabarié

FLASQUE AVANT ø22 - "HY" gabarié	
	21
	24
	25

Arbre			
CI001 - Cylindrique T.2 = 2.1 [Nm]	A	CF001 - Queue fraisée T.2 = 9.2 [Nm]	B
CF005 - Queue fraisée T.2 = 8.4 [Nm]	F	CO001 - Conique T.2 = 21.9 [Nm]	E

Couverture		
		E
Drainage extérieur		
		F
Drainage intérieur		
		K
IN + OUT + drainage		
		L
IN + OUT + drainage		
		P
Drainage sur la base		

Cylindrée	
TYPE	CODE
XV-OM/0.45	04
XV-OM/0.57	05
XV-OM/0.76	06
XV-OM/0.98	07
XV-OM/1.27	09
XV-OM/1.52	11
XV-OM/2.30	13

Corps standard			
Cylindrée	cm³/tour	Filetages standard	
		0.17	B - B
0.25	B - B	Z - Z	
0.45	B - B	Z - Z	
0.57	B - B	Z - Z	
0.76	B - B	Z - Z	
0.98	B - B	Z - Z	
1.27	B - B	Z - Z	
1.52	B - B	Z - Z	
2.30	B - B	Z - Z	

Tableau des combinaisons des bridages et filetages standard disponibles en magasin

Corps (filetages et bridages)													
	A		B		C		D		E		F		G
	H		I	Corps Renfermé		Z							